

# Abrasives Clearance Sale

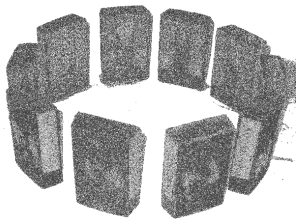

## Surface Grinding



Part No.	Description	Special	Qty
KB-35	SURF. SEGMENTS - K. I./PET. (50x16x90mm)- Sold Ind.	<b>\$12.95 ea.</b>	40
KBK-10	SURF. SEGMENTS - KW (65x20x100mm)- Set of 10	<b>\$89.75/set</b>	1 set
KBS-8	SURF. SEGMENTS - K.I./ PET. (79x21x79)- Set of 8	<b>\$99.95/set</b>	2 sets
BK2600	SURF. SEGMENTS- K.I./ PET. (79x21x79)- Sold Ind.	<b>\$14.95</b>	15
R2379268	1/2" CBN SPECIAL FOR DIESEL	<b>\$195.00</b>	1

## Valve Refacer Wheels

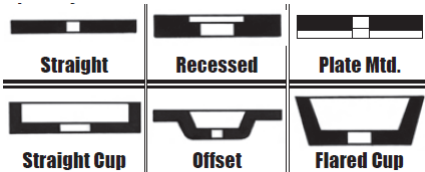

Part No.	Description	Special	Qty.
2304	V. Refacer Whl. 5x1 G.P.- Black & Decker	<b>\$29.95</b>	1
2312R	V. Refacer Whl. 5x7/8 Ruby - Kwik-Way	<b>\$24.95</b>	1
2316	V. Refacer Whl. 5x7/8 Stell.- Kwik-Way	<b>\$29.75</b>	4
2372	S. Refacer Whl. 10x1-3/4 G.P.- Win. VN	<b>\$69.50</b>	1
SS2358	V. Refacer Whl. 5x1-3/8 G.P.- Sunnen	<b>\$29.95</b>	3
REK-880R	Valve Refacer Whl. 6x3/8x3/4 Ruby- Sunnen	<b>\$49.50</b>	1
REK-926	Valve Refacer Whl. 10x1-1/4x3 Win. VN	<b>\$79.50</b>	1
KL7863	4-1/2" VALVE REFAKER WHL- HALL TOLEDO	<b>\$9.95</b>	5

## Honing Stones

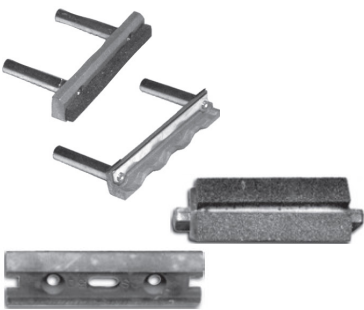

Part No.	Description	Special	Qty.
80984K	AN STYLE BOLT-ON BRACKET (2-3/4" TO 4-3/4") & 4 STONE SETS (80 & 400GR)	<b>\$69.97</b>	2
80800	AN Style Hone Brush Set- 320gr (3.0" to 4.1")	<b>\$95.99</b>	2
KL4972R	RUBY STONE-WIPER SET AN-200M	<b>\$14.95</b>	3
KL4973R	RUBY STONE-WIPER SET AN- 201M	<b>\$14.95</b>	5
KL4974R	RUBY STONE WIPER SET AN-300MF	<b>\$14.95</b>	1
KL5002RC	HONE STONE CR-12 RUBY	<b>\$4.95</b>	9
80983	UC-B Guide Shoes(pr) 0.900-1.003"	<b>\$19.95</b>	5

## Misc. Abrasives

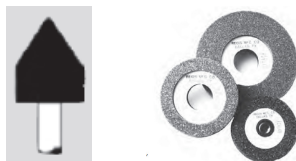

Part No.	Description	Special	Qty.
KL8287	8" FLYWHL GR WHL (VN 444)	<b>\$29.95</b>	1
A14	Mounted Point 11/16" x 7/8"	<b>\$2.95</b>	1
KL8346	6 x 3/4" Bench Grinder Wheel- 120gr	<b>\$14.95</b>	1
REK-424	Brake Drum Grinding Whl- VN	<b>\$9.95</b>	1

261250 Con. 18, Hanover, ON N4N3B8

[www.ccvalves.com](http://www.ccvalves.com)

TOLL-FREE: 1-877-574-4444

FAX: 519-364-5201

# Clearance Sale

## Port & Polishing Supplies



Part No.	Description	Special	Qty.
FW1021-120-1	1-1/2" X 1" X 1/4 FLAPWHEEL- 120GR	<b>\$2.95</b>	1
FW1022-80-1	2" X 1" X 1/4 FLAPWHEEL- 80GR	<b>\$4.95</b>	6
FW1024-60-1	1-1/2 X 1/2 X 1/4 FLAPWHEEL- 60GR	<b>\$2.95</b>	10
FW1025-80-1	1-1/2 X 1-1/2" X 1/4 FLAPWHEEL- 80R	<b>\$5.95</b>	10



Part No.	Description	Special	Qty.
2678	Straight Cart. Roll 3/4x1-1/2 40G.- 50/pk	<b>\$29.95</b>	1 pack
2738	Taper Cart. Roll 1/2x1-1/2 40G.- 50/pk	<b>\$19.95</b>	10 packs
2739	Taper Cart. Roll 3/4x2 80G.- 50/pk	<b>\$29.95</b>	1 pack
KL9331	Butterfly Strip Roll 1" x 5ft- 80gr	<b>\$2.95</b>	27



Part No.	Description	Special	Qty.
2712	Mandrel 1/4x1-1/2 Pilot	<b>\$4.75</b>	12
CRM1000	1/4 X 1-1/2 X 1/4 MANDREL	<b>\$2.50</b>	11
CRM1001	1/4" X 1" 1/4"-6" LONG MANDREL	<b>\$2.95</b>	12
CRM1011	3/16 X 1 X 1/4 MANDREL	<b>\$1.95</b>	12
CRM1021	1/8 X 1-1/2 X 1/4 MANDREL	<b>\$1.95</b>	8
CRM1022A	MANDREL 1/8"X1"X1/4"X2-3/4" LONG	<b>\$1.95</b>	12
CRM1030	3/32"x1"x 1/8"MANDREL	<b>\$1.95</b>	6
DRUM21100	1" x 1" x 1/4" Drum Mandrel	<b>\$3.95</b>	3

## Surface Preparation



Part No.	Description	Special	Qty.
2550	Surf. Conditioning Pad- 4" Coarse 10/pk	<b>\$14.95/pk</b>	1.5 packs
2554	Surf. Conditioning Pad- 2" Coarse 10/pk	<b>\$7.50/pk</b>	2.6 packs
2694	Quick Change Disc (Female)- 2" Coarse 10/pk	<b>\$7.50/pk</b>	3 packs
2561	Hand Cleaning Pads- 6" x 9"- 10/pk	<b>\$4.95/pk</b>	5 packs